

The Honolulu Academy of Arts

Welcomes you to the  
Twenty-Fourth Annual

*Kama'aina Christmas*

Silent Auction

Saturday, December 12, 2009

Honolulu Academy of Arts

# *Table of Contents*

Program .....	1
The Wish Tree .....	2
Cartier Christmas .....	5
Silent Auction Rules and Information .....	6
Silent Auction Map .....	8

## Silent Auction Listing

1	Academy Exclusives .....	9
101	Art .....	11
201	Dine, Wine and Diversions .....	19
301	Home .....	28
401	Adornments .....	40
501	Travel .....	43

# *Program*

## *Grey Goose Martini Reception*

6:00 p.m. - 7:30 p.m.

### **Central Court**

Hors d'oeuvres

Cartier Christmas

### **Luce Pavilion**

Wish Tree

## *Silent Auction*

6:00 p.m. - 10:00 p.m.

Cashiers located in the Luce Pavilion from 10:30 p.m.

## *Dinner in the Galleries*

7:30 p.m.

## *Dancing in the Central Courtyard*

9:15 p.m. - 11:00 p.m.

Music by Ginai and the Honolulu Jazz Quartet

# *The Wish Tree*

## *Located in the Luce Pavilion*

This year, the Kama'aina Christmas Committee asked managers of Academy departments to submit a list of budget-relieving items for the Wish Tree. While these items will serve to enhance the quality, quantity or efficiency of their department's work, they are also essential to the work that is done by the Academy and will help to make a difference in the operating budget as approved by the Board of Trustees. The following are the staff wishes.

This list will be displayed beside a fabulous bonsai tree loaned by Walter Liew during Kama'aina Christmas on Saturday, December 12, 2009. Please come visit the wishes at the Academy Shop's entrance.

To fulfill a staff wish make a selection from the Wish Tree at Kama'aina Christmas or call the Kama'aina Christmas Liaison, Denise Nakano at 532-3671 prior to the event. All contributions for Wish Tree items are fully tax deductible.

Academy Shop	Iced Tea for World Art Bazaar and Clearance	\$200
	Sale Volunteers	
	Foldable Photo Studio	\$265
	Professional Development Trip for	\$1,800
	Assistant Manager/Jewelry Buyer	
Art Center	10 - 72" x 120" Tablecloths	\$190
	Viewsonic Digital Projector	\$510
	Revo 16 Channel, 8 Camera DVR, HD, 19" Monitor	\$1,300
Art Maintenance	Digital Psychrometer	\$125
	22" Widescreen LCD Monitor Acer V223 WBD	\$210
	Desktop DC 7900 Core Duo E8500 HP Compaq	\$1,100
Asian Art	Fiberglass Stepladder	\$85
	Unbuffered Tissue Paper Roll - 2	\$500
	Art Storage Boxes 60" x 28" - 3 cartons	\$2,500
Communications	Merriam-Webster's Collegiate Dictionary	\$18
	2 Rolls of Vinyl for Ink-Jet Printer	\$275
	1 Order of GatorBoard for Exhibition Signage	\$1,200
Deputy Director	One Year Subscription to Honolulu Advertiser	\$200
	American Assn. of Museums Conference Registration	\$500
	Canon PowerShot Pro Series S5 IS	\$500

Development	Lei for Opening Receptions	\$175
	Annual Membership in Assn. of Fundraising Professionals	\$250
	Refreshments for Reception of <i>Whistler to Warhol</i>	\$1,500
Education	Admission to the Museum for 1 Class of Students	\$90
	Computer for the Docent Room	\$700
European & American Art	Artwork Storage Supplies	\$200
	Books & Research Materials	\$500
	Database Training in NYC for the Collections Manager	\$3,000
Film	One Bollywood Film Rental	\$500
	Macbook, 13 inch laptop	\$1,250
Finance	Office Depot Gift Card	\$200
	Ergonomic Task Chair	\$350
	Professional Shredder	\$550
Flowers	January	\$200
	February	\$200
	March	\$200
	April	\$200
	May	\$200
	June	\$200
	July	\$200
	August	\$200
	September	\$200
	October	\$200
	November	\$200
	December	\$200
Human Resources	Pendaflex File Supplies	\$100
	Staff Compliance Training with Hawaii Employers Council	\$350
Installation	Dremel 4000-6/50 Rotary Kit	\$150
	Metal Cutting Bandsaw	\$400
	Fletcher 3000 Wall Mount 60" Cutter	\$2,549
Information Technology	1 Internal Hard Drive	\$150
	3 Internal Hard Drives	\$450
	Server to Store HAA Digital Images	\$2,500

Library	Membership in the Hawaiian Historical Society	\$40
	Annual Membership in the National College Art Association	\$375
	Attendance at the annual Hawaii Library Association held on a neighbor island in 2010	\$900
Operational Services-Maintenance	Oval 22" x 26" Serving Trays	\$200
	Eureka Upright Sanitaire Vacuum Cleaner	\$265
	Architectural Services for Floor Plan Drawings	\$3,500
Operational Services-Physical	2 - 10' x 10' White Carnival Tent Covers	\$304
	2 HP Electric Motor Drain/Sewer Jetter	\$1,695
Pavilion Café	Salt & Pepper Shakers/Grinders	\$200
	Wooden Money Trays/Check Presenters	\$500
	Serving Trays, Platters & Bowls, Bar Glassware	\$700
Public Programs	Instrument Microphone	\$105
	12" LCD HD-Video Monitor	\$340
	Basic Laptop Netbook	\$540
Recycling	Biodegradable Take-out Containers for the Café	\$500
	Recycling Collection Bins for Workspaces	\$750
Registrar	Optivisor with Lens Plate	\$55
	Adobe Creative Suite 4 Design Standard	\$450
	HP Compaq Business Netbook 6730b	\$1,100
Security	2 - SS9 61 Watt Megaphones	\$170
	Radio Batteries, Earpieces, Flashlights & First Aid	\$500
	CPR, AED Certification/Training for 2 years	\$2,059
Textiles	Membership to Textile Society & Surface Design	\$250
	Signage & Paint for One Textile Gallery Exhibition	\$450
Visitor Services	Laser Printer	\$200
	Windows Desktop Computer	\$500
	HAA Admission Stickers for Visitors	\$2,000
Volunteer Services	Underwriting for Volunteer Appreciation Brunch	\$200
	Underwriting for Volunteer Appreciation Brunch	\$500
	Underwriting for Volunteer Appreciation Brunch	\$500
Website Redevelopment	Apple iWork & Tripod	\$112
	Flip HD Video Camera	\$250
	Localization for New Website	\$1,125

*Make it a  
Cartier Christmas!*

*Find out what Cartier has  
in store for you this year!*

*Your gift box may contain a ticket  
for one of three luxurious  
Cartier gifts on display at  
Kama'aina Christmas*

<i>1 gift box</i>	<i>\$25 donation</i>
<i>5 gift boxes</i>	<i>\$100 donation</i>

*Cartier gift boxes make thoughtful gifts for your tablemates!  
The winners will be announced at Kama'aina Christmas.*

*Gift boxes are available at the Preview Party  
or at Kama'aina Christmas.  
Or you may call 532-8746 in advance to have  
your gift boxes waiting for you  
the evening of the event.*

# Silent Auction Information and Rules

*Please read carefully*

## **Silent Auction Procedures**

The complete auction will be available for viewing and bidding at the Preview Party on Wednesday, December 9, 2009, from 5:30 p.m. to 7:30 p.m. and at Kama'aina Christmas on Saturday, December 12, 2009, from 6:00 p.m. to 10:00 p.m.

## **Bidding Process**

A bid sheet will be displayed with each item. Bids can be entered by legibly writing your name and telephone number and correct bid increment on the bid sheet. Please note and follow starting bids and minimum increments. You may bid on any item in the silent auction until the auction closes at **10:00 p.m.** on December 12, 2009. The highest valid bid at closing is the winning bid. If two or more bidders are bidding on the same item at closing time, the bid sheet will not be picked up from the table until the bidding has ended. Bidders must be present in person to continue bidding. In the event of a dispute, the Kama'aina Christmas Chairpersons will determine the prevailing bidder. At closing time, a silent auction attendant will circle the winning bid and collect the bid sheets. Please check the remaining bid sheet to find out if you are the highest bidder.

## **Payment**

The highest bidder on each item will be responsible for payment on the evening of Kama'aina Christmas by cash, credit card (Master Card, VISA, AMEX) or check. All sales are subject to a 4.712% Hawaii general excise tax. Cashiers will be ready to receive payment for your item(s) at **10:30 p.m.** All sales are final with no exchanges or refunds. Items purchased become the property of the successful bidder upon checkout. Payment is expected in full and all items must be removed from the premises on the evening of the auction unless otherwise noted. Please see the cashiers if size or weight prevents removal. Arrangements must be made the night of the auction. **If you prefer to pick up winning silent auction items on Sunday, December 13, 2009, pick up of silent auction items will be available from 1:00 p.m. - 4:00 p.m. at the Events Office, 2nd Floor, Banyan Courtyard. Entry through Ward Avenue Gate.**

In the event the winning bidder is not present when the auction closes, the winning bidder will be called during the following week with a request to arrange for payment and removal of auction item(s).

## **Restrictions**

Please adhere to the conditions specified in the restrictions set by our donors. ALL ITEMS ARE VALID UNTIL DECEMBER 12, 2010, UNLESS OTHERWISE SPECI-

FIED. If otherwise specified, the expiration date is as it appears and may not be changed.

Dates for services, vacation homes, private dinners and the like are to be arranged for mutual convenience between donor(s) and purchaser(s). Time periods designated for use of homes, restaurants, merchandise certificates, services and hotels are not subject to change. All certificates exclude taxes, gratuities, and alcoholic beverages, unless otherwise specified. Certificates are not replaceable or extendable. Unless otherwise specified, hotel certificates are based on availability, subject to blackout periods including holidays and special days and must be used for consecutive nights. Certificates are neither transferable to another person or hotel nor redeemable for cash. Original certificates must be presented at the time services are to be rendered. When private homes are included, the property must be used as specified and must be returned in the condition in which donated.

EACH ITEM IS AUCTIONED 'AS IS' WITHOUT WARRANTY OF ANY KIND BY THE HONOLULU ACADEMY OF ARTS. THE HONOLULU ACADEMY OF ARTS AND THE ACADEMY GUILD MAKE NO REPRESENTATIONS OF ANY KIND OR NATURE, EXPRESS OR IMPLIED, WITH RESPECT TO THE ITEMS OFFERED AT THIS AUCTION.

Values assigned to some items being auctioned are estimates only, and are not warranted or guaranteed by the Honolulu Academy of Arts for tax purposes or for general use. Best efforts to identify the type, quality, quantity and weight of materials used in jewelry items have been made; however, the information provided should be considered estimates.

The Honolulu Academy of Arts reserves the right to withdraw any item from sale prior to the closing of bids.

### **Tax Deductibility**

Successful bidders who wish to have a part of their bid considered as a tax deduction should be aware of the following: if the amount of your bid exceeds the retail or fair market value of the item purchased, you may consider the difference as a tax-deductible contribution. Please consult your tax professional regarding how these guidelines may apply to you. All items for Kama`aina Christmas have been donated in full or in part by the persons or companies listed with each item.

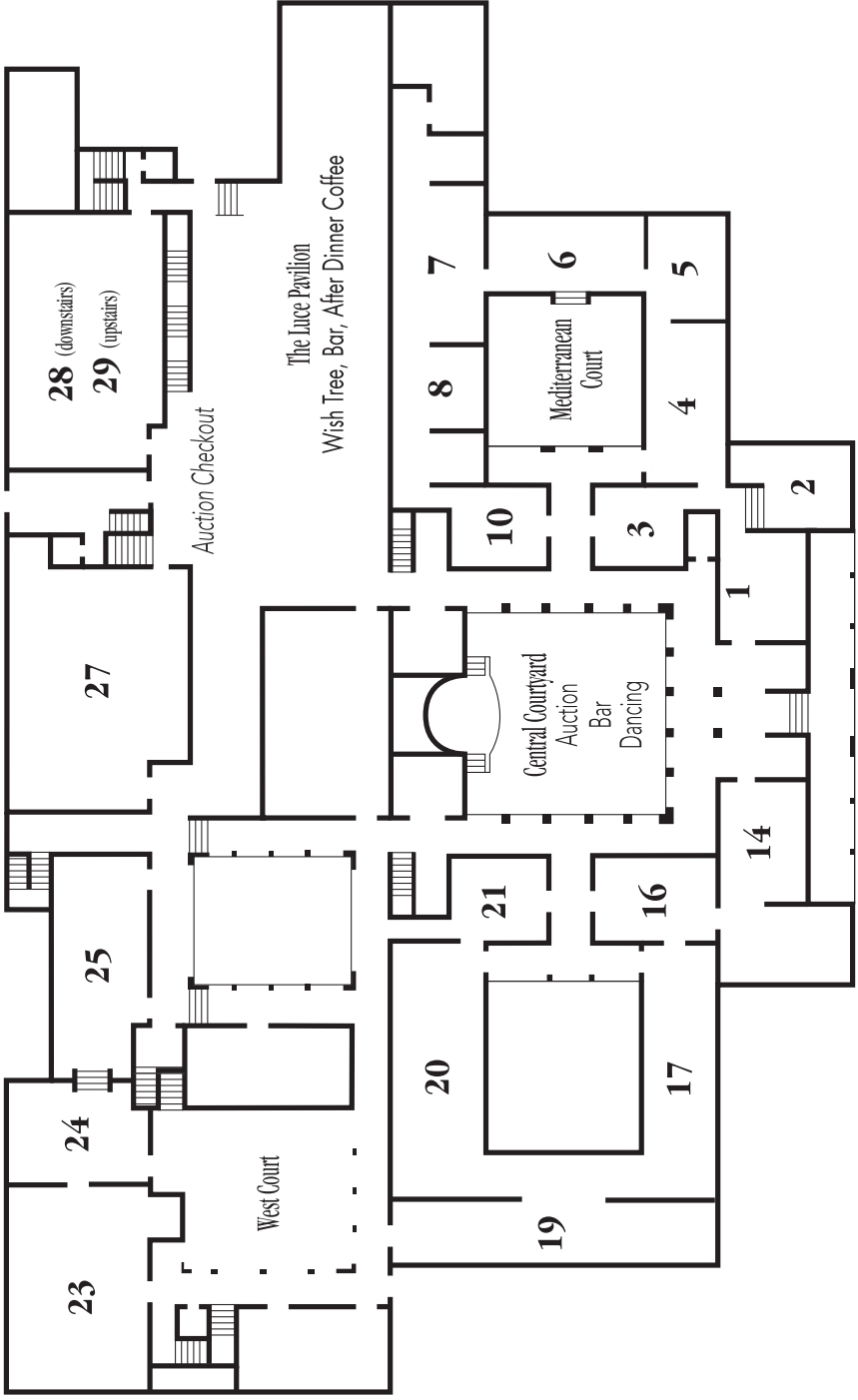

# Academy Exclusives

## 1 *Art, Salon and Supper: Director's Behind the Scenes Tour of the Richard Lane Collection*

The Academy revives the tradition of the art salon for Kama'aina Christmas guests. Academy Director Stephen Little will lead a private tour of extraordinary treasures from the recently-acquired Richard Lane Collection of Japanese Art. Then you and 15 guests will head to one of the Academy's courtyards to continue your conversation with Steve over a candlelit buffet supper. *Due to museum security issues this tour starts at 5:30 p.m. Date to be mutually agreed upon. Expires December 12, 2010.*

**Stephen Little, Director,  
The Pavilion Café, Honolulu Academy of Arts**

**Value:** Priceless

---

## 2 *Deputy Director's Architectural Tour of the Academy*

A two-hour tour for a party of six followed by lunch at the Pavilion Café with Deputy Director Rob Saarnio sharing his architectural history expertise to give a unique insider's view of the Academy and its surroundings. Tour includes: information about Academy architect Bertram Goodhue, the Academy's listing on the National Register of Historic Places, subsequent architectural additions and the history of the Linekona Building, Thomas Square and its origins. *Tuesday through Saturday only. Date to be mutually agreed upon. Expires December 12, 2010.*

**Robert Saarnio, Deputy Director,  
The Pavilion Café, Honolulu Academy of Arts**

**Value:** Priceless

---

## 3 *Art, Salon and Supper: Preview of Four Thousand Years of Southeast Asian Art*

A unique evening of Art & Entertainment awaits you and your fifteen guests. Asian Art Curator Shawn Eichman will lead an exclusive after-hours preview of *Four Thousand Years of Southeast Asian Art*, the Academy's major exhibition for Summer 2010. After a behind-the-scenes tour of the objects that will become part of this exhibition, you and your guests will enjoy a candle-light buffet supper in one of the Academy's courtyards. A return to the Art Salon! *Due to museum security, this tour starts at 5:30 p.m. Date to be mutually agreed upon. Expires July 2010.*

**Shawn Eichman, Curator of Asian Art,  
The Pavilion Café, Honolulu Academy of Arts**

**Value:** Priceless

---

4 *Art, Salon and Supper: After-Hours Tour of From Whistler to Warhol*

Entertain 15 of your closest friends at this artful night to remember. Theresa Papanikolas, Curator of European and American Art, will give you and your guests an after-hours tour of *From Whistler to Warhol: Modernism on Paper* (Feb 17-May 2, 2010), which includes art world giants such as Gauguin, Degas, Lichtenstein and Rauschenberg. After the feast for the eyes, you can feast on chef Mike Nevin's special supper buffet inspired by the Cubist drawings of Pablo Picasso and Georges Braque. *Due to museum security issues this tour starts at 5:30 p.m. Date to be mutually agreed upon. Expires May 2, 2010.*

**Theresa Papanikolas, Curator of European and American Art,  
The Pavilion Café, Honolulu Academy of Arts** **Value:** Priceless

---

5 *Fine Art and Fine Food*

The Chef Mavro team will prepare an art-inspired three-course dinner for ten at the Academy's elegant 1952 Ossipoff-designed Goodwill House, which serves as the Director's residence. Chef George Mavrothalassitis will select a painting from the Academy's collection as a muse for the dinner. At the dinner, Dr. Little will share insight about the painting, and Chef Mavrothalassitis will talk about how it inspired the food. The meal will be beautifully presented and served by professionals from Royal Party Rentals and The Catering Connection. *Date and time to be mutually agreed upon by all parties. Expires December 12, 2010.*

**George Mavrothalassitis/Chef Mavro,  
Stephen Little, Director of the Honolulu Academy of Arts,  
Pat Loui, Royal Party Rentals,  
The Catering Connection** **Value:** Priceless

---

6 *Find Your Inner Artist*

Tuition for one adult art class and one Young Artist Class. *Lab fees not included. Not replaced if lost or stolen. Not redeemable for cash. Based on availability. Expires December 12, 2010.*

**Art Center at Linekona  
Honolulu Academy of Arts** **Value:** \$210

---

7 *The Big Picture*

Get the Doris Duke Theatre all to yourself—and 279 of your closest friends. The event includes a private consultation with Academy Film Curator Gina Caruso to select a film. You will also have the use of the Pavilion Café for a pre- or post-film reception. *Date to be mutually agreed upon by all parties involved. Catering/food/beverage not included. Expires December 12, 2010.*

**Gina Caruso, Academy of Arts Film Curator,  
Doris Duke Theatre at the Honolulu Academy of Arts,  
The Pavilion Café** **Value:** \$6,000

---

8 *Flemish Tapestry*

Flemish tapestry ranks among the most luxurious and skillful textile traditions in the world. This antique fragment from the late 17th century depicts a woodland motif in reds, blues and browns. 70% wool, 30% silk.

**Michael Haig** **Value:** \$8,500

*Art*

101 *“Cannes” Watercolor*

Sir William Russell Flint watercolor of “Cannes”.

**Anonymous** **Value:** \$500

---

102 *Woman in a White Dress*

French portrait oil painting circa 1810 on canvas depicting a woman in a white dress with lace trim reading a book. Unsigned, mounted in a molded gilt frame.

**Anonymous** **Value:** \$2,000

---

103 *Gentleman in a Coat*

American portrait oil painting on canvas, circa 1830s, depicting a gentleman in a dark coat. Unsigned and framed.

**Anonymous** **Value:** \$1,500

---

104 *Bogert Woodland Scene*

American landscape oil painting on canvas by George Hirst Bogert (1864-1923), who studied under Thomas Eakins. The untitled piece depicting a dark woodland scene is signed Bogert on the lower right. It is mounted in an elaborately carved and molded gilt frame.

**Anonymous** **Value:** \$3,000

---

105 *“Berkeley Hills”*

William Keith (1838-1911), a prominent San Francisco painter at the turn of the century, has works in the Corcoran Gallery of Art, de Young Museum and Museum of Fine Arts, Boston.

**Anonymous**

**Value:** \$5,000

---

106 *Callahan Oil*

“The Peaceful Hour” oil painting by C. R. Callahan.

**Anonymous**

**Value:** \$5,000

---

107 *“Morning Bath”*

A large pastel by Robert Brackman.

**Anonymous**

**Value:** \$1,500

---

108 *“Commodore” and Hawai‘i Shipping History*

Original oil on composition board. The “Commodore” was a Lewis & Cooke schooner built in the early 1920s. She carried millions of feet of lumber from the Pacific Coast to Hawaii. The painting depicts a four-masted sailing ship at sea with all lower sails rigged and seagulls off the stern.

**Wilma Odo Lovell**

**Value:** \$3,500

---

109 *Architectural Art*

A pair of Chinese filigree architectural elements from the 19th century.

**Anonymous**

**Value:** \$1,000

---

110 *Silk Scroll*

Pre-Cultural Revolution Chinese scroll is a hand-painted scene of life along Yangtze River. Silk mounted on paper. Exquisite details and authentic colors.

**Chuck Y. Gee**

**Value:** \$3,000

---

111 *Child’s Collar*

A hundred years ago, clothing for children in China was woven, cut and stitched by mothers, sisters and aunts in the home. This is a child’s collar from 19th century China.

**C.S. Wo & Sons, Ltd.**

**Value:** \$1,380

---

112 *Meiji Fisherman*

Meiji period bronze fisherman on a stand.

**Douglas Himmelfarb**

**Value:** \$2,000

---

113 *Usubata Vase*

Japanese bronze with silver inlay usubata vase used for flower arranging. Meiji period, late 19th century.

**Anonymous**

**Value:** \$1,200

---

114 *Floral Textile*

Framed floral Tsutsugaki textile, dyed cloth using rice paste to create a particular design. By squeezing the rice paste through a paper cone, the textile artist draws, freehand, the chosen design. 20th century, cotton.

**Anonymous**

**Value:** \$1,800

---

115 *“31 Flavors Invading Japan/Today’s Special”*

Internationally recognized artist Masami Teraoka often depicts cross-cultural themes in his art. This print from his famous series on American brands entering the Japanese market was created with 35 hand-carved blocks of cherry wood, natural dyes and additional hand coloring on handmade Hosho paper. Signed and numbered in pencil on the verso.

**Masami Teraoka courtesy of  
Catharine Clark Gallery, San Francisco**

**Value:** \$3,000

---

116 *Green Onion Flower Carriage*

Title is the translation of the kanji. Ink on paper by an unknown artist, Japanese.

**Bank of Hawaii**

**Value:** \$450

---

117 *Phoenix Carriage*

Title is the translation of the kanji. Ink on paper by an unknown artist, Japanese.

**Bank of Hawaii**

**Value:** \$450

---

118 *Kansai Era Phoenix Carriage on Display at  
The Imperial Palace*

Title is the translation of the kanji. Ink on paper by an unknown artist, Japanese.

**Bank of Hawaii**

**Value:** \$450

---

119 *Kujo Family Rickshaw*

Title is the translation of the kanji. Ink on paper by an unknown artist, Japanese.

**Bank of Hawaii**

**Value:** \$450

---

120 *“Japanese Candlesticks”*

Three digital prints on paper of three Japanese candlestick patterns: “Inverted Hammer,” “Harami Cross” and “Bearish Engulfing” by Jodi Endicott. These are specific chart patterns used by stock traders to determine when to enter or exit a trade. Signed by the artist.

**J. Endicott**

**Value:** \$675

---

121 *“Longevity, Korea”*

Woodblock print by Paul Jacoulet. Signed, watermark in paper with peach seal.

**Anonymous**

**Value:** \$1,200

---

122 *Thai Bronze Buddha*

Contemporary Thai bronze U Thong B style seated Buddha posed in the bhumisparsha mudra, the ushnisha supporting a stylized flame characteristic of the U Thong B style. Heavy green surface oxidation.

**Anonymous**

**Value:** \$1,000

---

123 *“Vision of Cham”*

Hand-painted, digital photograph of dancing Bhutanese monks on watercolor paper by Heloisa Oliveira.

**Heloisa Oliveira**

**Value:** \$600

---

124 *“White Ginger”*

Margaret Fleming silver plated presentation plate with a design of “White Ginger” is part of a series created around 1930 for Grossman Moody. The plate is signed by the artist on the back. Margaret Fleming plates are on display at the Honolulu Academy of Arts.

**Michael and Linda Horikawa**

**Value:** \$1,800

---

125 *“Golden Shower”*

Margaret Fleming silver plated presentation plate with a design of “Golden Shower” is part of a series created around 1937 for Grossman Moody. The plate is signed by the artist on the back. Margaret Fleming plates are on display at the Honolulu Academy of Arts.

**Michael and Linda Horikawa**

**Value:** \$1,800

---

126 *“Hula Movement” by Madge Tennent*

Lithograph by Madge Tennent. Honolulu Print Makers gift print for 1941.

**Anonymous and Jeff Liu, Island Art and Framing**

**Value:** \$1,200

---

127 *John Young Oil*

Impressionistic oil in grays on canvas. 5' X 4'.

**Anonymous**

**Value:** \$4,000

---

128 *“Kapa Hana”*

Aquatint etching by John Kelly, signed in pencil by the artist and numbered 8, circa 1934.

**The Honolulu Academy of Arts and  
Robyn Buntin of Honolulu**

**Value:** \$1,900

---

129 *“Lau Hala”*

Etching by John Kelly, signed in pencil by the artist and numbered 6, circa 1934.

**The Honolulu Academy of Arts and  
Robyn Buntin of Honolulu**

**Value:** \$1,900

---

130 *“Making Nets”*

Aquatint etching by John Kelly, signed in pencil by the artist and numbered 5, circa 1934.

**The Honolulu Academy of Arts and  
Robyn Buntin of Honolulu**

**Value:** \$1,900

---

131 *Sueda Oil*

Original oil on canvas by Kelly Sueda.

**Kelly Sueda**

**Value:** \$2,000

---

132 *Pegge Hopper Original*

Pegge Hopper original charcoal on canvas.

**Pegge Hopper**

**Value:** \$2,000

---

133 *“Ocean”*

Painting by Peter Hayward.

**Mr. and Mrs. H.C. Sharp**

**Value:** \$4,500

---

134 *“Volcano”*

Acrylic painting by Sky Williams.

**Bank of Hawaii**

**Value:** \$1,800

---

135 *Chris Campbell Watercolor*

Original watercolor.

**Chris Campbell**

**Value:** \$650

---

136 *Dorothy Faison Original*

Original work on paper.

**Dorothy Faison**

**Value:** \$650

---

137 *“Waimanalo Beach Cottage”*

Original watercolor painting by Nancy Poes painted in 1993. Framed in koa.

**Greg Northrop**

**Value:** \$1,500

---

138 *“Five Birds”*

A splash of color enlivens the elegant line drawings of five birds by Jodi Endicott.

**J. Endicott**

**Value:** \$900

---

139 *Mixed Media*

Mixed media art piece by Tsugumi Iwasaki-Higbee.

**Joe and Joan Farrell**

**Value:** \$400

---

140 *“Banana Trees & Plants”*

Framed watercolor by Juanita Kenda, American artist, 1922-2000. The piece is signed and dated on the lower right.

**Anonymous**

**Value:** \$500

---

141 *“Girl with Camera”*

Oil on canvas with gold leaf paint by local artist Carrie Able.

**Anonymous**

**Value:** \$150

---

142 *“Tuscan Garden”*

Painting by Russell Lowrey. Framed 18” X 18”.

**Russell Lowrey**

**Value:** \$650

---

143 *“Yellow Sunset Breaking Wave”*

Painting by Russell Lowrey. Framed 18” X 18”.

**Russell Lowrey**

**Value:** \$650

---

144 *“Cloudscape and Ocean”*

Painting by Russell Lowrey. Framed 18” X 18”.

**Russell Lowrey**

**Value:** \$650

---

145 *“Mokoli‘i Island”*

Painting by Russell Lowrey. Framed 18” X 18”.

**Russell Lowrey**

**Value:** \$650

---

146 *JK at Amikopala, Molokai*

A photo print of kumu hula, JK, taken at the beginning of an almost three-decade collaboration between the photographer, Philip Spalding III and JK. This is the first offering of this image. It is signed by the photographer.

**Philip Spalding III**

**Value:** \$250

---

147 *“Meridian”*

Acrylic on canvas by Stephen Little.

**Stephen Little**

**Value:** \$1,000

---

148 *Paper Waves*

Paper sculpture by Karen Laubhan in a Plexiglass box.

**Greg Northrop**

**Value:** \$4,000

---

149 *Sculpture in Glass*

Blown glass plate by Ivon Treskow has a clear background accented with splashes of blue, orange, yellow and brown.

**Greg Northrop**

**Value:** \$400

---

150 *Stained Glass*

Stained glass window by a local female artist has a lotus flower design at the bottom and leaves toward the top, 7 feet by 2 1/2 feet.

**Anonymous**

**Value:** \$1,500

---

151 *Raku*

Green and black legged raku vessel by Russell Wee.

**Greg Northrop**

**Value:** \$800

---

152 *Satoru Abe Sculpture*

Signed by the artist, this piece is a representation of an old tree with new leaves.

**Anonymous**

**Value:** \$5,000

---

153 *Aaron Padilla Sculpture*

Abstract original wood sculpture.

**Aaron Padilla**

**Value:** \$500

# *Dine, Wine and Diversions*

## *201 Indian Food and Art Infusion*

Internationally known Indian-born chef Vikram Garg, the Executive Chef at the Halekulani Hotel, will prepare a fabulous Indian meal for ten guests at the beautiful, art-filled apartment of Indru and Gulab Watumull. Classically trained in Indian and French cuisines, Garg uses imported spices and rubs in innovative ways. *Date and time to be mutually agreed upon with a minimum two weeks advance planning. No special dietary restrictions or allergies can be accommodated. Expires December 12, 2010.*

**Indru and Gulab Watumull,  
Chef Vikram Garg and Halekulani Hotel**

**Value:** Priceless

---

## *202 I'm Drinking Stars!*

Dom Perignon 1998 vintage with two Reidel champagne flutes. A stronger vintage than expected, the 1998 exhibits aromas and flavors of lemon oil, orange rind and brioche in a medium bodied, zesty, rich, moderately intense style. Riedel Vinum champagne flutes make every drop taste its best.

**Michael and Linda Horikawa**

**Value:** \$300

---

## *203 I'm Drinking Stars Too!*

Dom Perignon 1998 vintage with two Reidel champagne flutes. A stronger vintage than expected, the 1998 exhibits aromas and flavors of lemon oil, orange rind and brioche in a medium bodied, zesty, rich, moderately intense style. Riedel Vinum champagne flutes make every drop taste its best.

**Michael and Linda Horikawa**

**Value:** \$300

---

## *204 The Art of Cooking*

Ed Kenney, the chef-owner of Town, will cook dinner for ten at the home of noted Hawai'i artist Kelly Sueda. Meet the artist and discover his artistic process accompanied by contemporary Mediterranean-accented food, drink and friends. *Date and time to be mutually agreed upon with a minimum two weeks advance planning. No special dietary restrictions or allergies can be accommodated. Expires December 12, 2010.*

**Chef Ed Kenney/town and Kelly Sueda**

**Value:** Priceless

---

## 205 *Just Ducky*

Six bottles of 2008 Duckhorn Napa Valley Sauvignon Blanc. The aromas highlight bright citrus notes of lemon zest, grapefruit and kaffir lime underscored by subtle hints of pear and dried apricot. Echoing the aromatics, the palate reveals vibrant citrus layers complemented by more subdued tropical elements of banana, coconut and lychee.

**Jack and Leilani Maguire**

**Value:** \$180

---

## 206 *Honolulu Vista*

Cocktails and dinner for eight people prepared by Erik Stenson and Timothy Choy. Dinner will be served in Tim's apartment overlooking Honolulu Harbor amidst a collection of art and antiques. *Date and time to be mutually agreed upon with a minimum 2 weeks advance planning. No special dietary restrictions or allergies can be accommodated. Expires December 12, 2010.*

**Dr. Timothy Y.C. Choy and Erik Stenson**

**Value:** Priceless

---

## 207 *2000 Brut Champagne Cuvee Dom Perignon*

This champagne starts out round and plush, then the structure takes over. Light peach and berry flavors prevail as this plays out on the lingering finish. Give it a little time to integrate, but this should develop well. Best from 2009 through 2024. WS 91.

**Cecilia and Gene Doo**

**Value:** \$150

---

## 208 *Bubbly*

Krug Champagne.

**Mr. and Mrs. Ash Matar**

**Value:** \$450

---

## 209 *A Night in Madrid*

A Spanish dinner for six in the home of Steven Prieto and Dr. Richard Kennedy. Madrid-trained Steven Prieto will prepare a delicious meal with a Spanish flair. *Date and time to be mutually agreed upon with a minimum two weeks advance planning. No special dietary restrictions or allergies can be accommodated. Expires December 12, 2010.*

**Dr. Richard Kennedy and Steven Prieto**

**Value:** \$500

---

## 210 *2007 Ultreia de Valtuille*

2007 Ultreia de Valtuille from winemaker Raul Perez is a dry red wine made from Mencia grapes. This wine is extremely rare with only 315 cases made and only 15 cases imported into the U.S. The 2005 vintage was rated 98+ by Robert Parker.

**Hawaii Food & Wine Paradise/Keola Lloyd**

**Value:** \$300

---

## 211 *Raul Perez 2007 El Pecado*

"The 2007 El Pecado is 100% mencia from the DO of Ribera Sacra. Its ethereal aromas are reminiscent of a great vintage of La Tache, leading to a layered, sweet, elegant wine with tons of spice that seem to melt in the mouth." Jay Miller. WA 98 points.

**Hawaii Food & Wine Paradise/Keola Lloyd**

**Value:** \$300

---

## 212 *Garden Lunch*

A tour of The Leland Miyano Garden followed by brunch for six created by Karen Miyano. In 2008, the Academy awarded Leland Miyano with the Catherine E.B. Cox Award for excellence in the visual arts. *Not available November through January. Date to be mutually agreed upon. No special dietary restrictions or allergies can be accommodated. Expires December 12, 2010.*

**Leland and Karen Miyano**

**Value:** \$400

---

## 213 *Two Chardonnays and a Sauvignon Blanc*

2006 Kistler Chardonnay, Dutton Ranch is structured and tannic, with more acidity, and a leaner, more backward personality with a chalky character. White currant, hazelnut and wood spice notes are present in this medium-to full-bodied white. WA 92-94 Points. 2006 Pahlmeyer Chardonnay is concentrated and intense in style. Aromas of hazelnut, mineral, tropical fruit and exotic lychee combine with a rich, creamy and complex palate that is kept balanced and lively with perfectly integrated acidity and toasty oak components. The wine ends with a long and lingering finish. RP 95. 2007 Peter Michael Chardonnay, L'Après Midi Sauvignon Blanc is tangy and ripe with excellent depth and hint of fig compote, grass and citrus rind.

**Cheryl and George Hetherington**

**Value:** \$305

---

## 214 *Views with a View*

Lunch for six with the former governor and first lady, Ben and Vicky Cayetano at the First Hawaiian Bank Banker's Club with expansive views of Honolulu Harbor, the airport and the West Oahu coastline. Get the inside scoop on politics during the Cayetano years and current state of the State of Hawai'i from someone with a unique perspective. *Date and time to be mutually agreed upon. Expires December 12, 2010.*

**Ben and Vicky Cayetano**

**Value:** \$300

---

## 215 *Turley Vertical*

Three bottles of Turley Dusi Ranch, Paso Robles Zinfandel one from 2005 (RP90), the second from 2006 (RP93), and the third from 2007 (RP93) for a great vertical tasting. The world's premier Zinfandel specialist, Larry Turley, deserves remarkable credit for his "holy grail" quest to locate largely forgotten parcels of old Zinfandel vines and preserve as many of these historic sites as possible. – Robert Parker.

**Leonard Chow**

**Value:** \$225

---

## 216 *Experience with Artist Clarence Lee*

Clarence Lee, the first Asian-American graphic designer selected to design the Chinese Lunar New Year stamps for the U.S. Postal Service will host a lunch for up to ten friends at The Pavilion Café and discuss the fascinating details of creating each of the twelve stamps in the series. *Date and time to be mutually agreed upon. Expires December 12, 2010.*

**Clarence Lee**

**Value:** \$500

---

## 217 *A Wine to Remember*

2003 Paul Hobbs Beckstoffer to Kalon is supple and elegantly styled with rich flavors built around a core of creamy oak, ripe currant, black cherry and herbal sage flavors that are intense and complex without being heavy. Finishes with a tight focus and rich tannins. Best from 2008 through 2012. WS 92, Robert Parker 91.

**Cecilia and Gene Doo**

**Value:** \$275

---

## 218 *1995 Caymus*

1995 Caymus Special Select is sleek and well-structured with a braid of exotic smoke, currant, green olive and herbal flavors that drape together nicely, holding a tight focus and showing how ripe, supple tannins can integrate without dominating. Finishes with a dash of mocha and spice. 1995 California Cabernet retrospective. Drink now through 2010. WS 93.

**Cecilia and Gene Doo**

**Value:** \$130

---

## 219 *Sunset Tour of Manoa Heritage Center*

A VIP Sunset Tour for ten guests of the Manoa Heritage Center's Native Hawai'ian Garden and Kukao'o Heiau followed by a visit to the historic Kauli'i Cooke home with its stunning art collection. *Maximum of ten people. Date and time to be mutually agreed upon. Expires December 12, 2010.*

**Samuel and Mary Cooke**

**Value:** Priceless

---

## 220 *Big Red*

A signed 1.5 liter bottle of Duckhorn Paraduxx 2003 Napa Valley Red. Paraduxx's goal is to craft a world-class blend with a distinctly Californian personality by using Zinfandel, a grape synonymous with California, Merlot and Cabernet Sauvignon.

**Mr. and Mrs. Watters O. Martin, Jr.**

**Value:** \$170

---

## 221 *Teppan-Yaki*

Specializing in teppan-yaki, shabu-shabu and sukiyaki, the service at Restaurant Suntory is phenomenal. Try it with a \$100 gift certificate. *No cash redemption, will not be replaced if lost or stolen. Must be present at time of use. Expires December 12, 2010.*

**Restaurant Suntory**

**Value:** \$100

---

## 222 *Chronicle Pinot*

2006 Chronicle Pinot Noir. Chronicle is a premiere brand of Luna Vineyards.

**Hawaii Food & Wine Paradise/Keola Lloyd**

**Value:** \$50

---

## 223 *Dining on the Edge of Chinatown*

\$100 gift certificate for Indigo, an oasis of tropical glamour, with indoor and outdoor seating, award winning menus and nationally recognized wine list, all delivered with unparalleled hospitality and service. *No cash value. Tip not included. No extensions. Expires October 15, 2010.*

**Indigo**

**Value:** \$100

---

## 224 *Kistler Vertical*

Two bottles of McCrea Vineyard, Athearn Estate, Sonoma Mountain Kistler Chardonnay. One from 2004 and the second from 2005. The 2004 "...shows wonderful, exotic aromas of zesty pear, apple and flowers, with pretty toasty, creamy oak and yeasty, leesy shadings. Adds a minerally quality on the palate, with a long, persistent finish." James Laube, WS 93. The 2005 has "rich, smoky marshmallow, fig, citrus, melon and nutmeg scents that are elegant and understated. The flavors fan out nicely ... ending with a clean, lively finish." James Laube, WS 90.

**Nan Baker**

**Value:** \$260

---

## 225 *Plumeria Beach Buffet*

Gift certificate for the breakfast buffet for two at the Plumeria Beach House. Gratuity and beverages not included. Not valid on holidays. Certain restrictions apply. Mention the gift certificate when making the reservation. Cannot be used in conjunction with other promotions or special rates. Not replaced if lost or stolen. No extensions. No cash value. Expires December 12, 2010.

**The Kahala Hotel & Resort**

**Value:** \$60

---

## 226 *Buzz's, It's a Tradition*

Two \$25 gift certificates for Buzz's Original Steak House, specializing in kiawe broiled steak, fresh fish and bountiful salads. Certificates can be used at either Lanikai or Pearl City location. Redeemable for food, liquor or merchandise purchases, but not cash. Restaurant not responsible for lost, stolen or damaged cards or any unauthorized use.

**Buzz's Original Steak House**

**Value:** \$50

---

## 227 *Chanticleer Sangiovese*

2007 Chanticleer Sangiovese, from winemaker Chris Deardon, one of the top two Sangiovese from Napa Valley. The 2007 Sangiovese is a wine with characteristic dusty cherry/allspice notes in the nose, along with aromatic toasty oak and mineral notes. The mouth feel is lush and rich, with an elegance that befits Sangiovese. The addition of 13% Cabernet Sauvignon from the same Morningside Vineyard adds weight, shoulders and dense color.

**Hawaii Food & Wine Paradise/Keola Lloyd**

**Value:** \$50

---

## 228 *Sushi Anyone?*

True to its South Beach, Miami flagship, this is a hip, swanky sushi spot with the most extensive sake selection in the U.S. Check it out with a \$50 gift certificate. No cash value. Not responsible for lost or stolen cards. Expires December 12, 2010.

**Doraku Sushi**

**Value:** \$50

---

## 229 *Kistler Pair*

Two bottles of Kistler 2004 Dutton Ranch, Russian River. The light gold-colored, full-bodied, intense 2004 Chardonnay Dutton Ranch displays evolved fruit notes in the nose of waxy peaches, honeysuckle and wood. The showiest, most flamboyant of these 2004 vintages.

**Stephanie and Mark Johnson**

**Value:** \$260

---

## 230 *Dinner for Eight*

Chef Yves Garnier has kept the Halekulani's La Mer at the top of the luxe restaurant lists. The nine-course Degustation Dinner pairs Garnier's indulgent specialties with stellar wines. This will be a night of culinary pampering for eight. *Inclusive of service charge and taxes. Not valid on holidays, subject to availability. Expires December 12, 2010.*

**Halekulani Corporation**

**Value:** \$2,275

---

## 231 *1996 Chateau Pinchon Longueville*

1996 Chateau Pinchon Longueville Lalande has a wonderful perfume of blackberry, Indian spice and eucalyptus. Full-bodied with velvety tannins and firm tannins. It needs some time to loosen up. '95/'96 Bordeaux retrospective. Best after 2008. WS 92.

**Cecilia and Gene Doo**

**Value:** \$180

---

## 232 *2004 Mondavi Reserve*

2004 Robert Mondavi Reserve Cabernet Sauvignon weaves together a complex array of ripe, rich currant, anise, smoky oak and black cherry. The wine is dense, concentrated and persistent with great depth and focus. It ends with an amazingly long, richly flavored finish. Best from 2008 to 2018. WS 95.

**Cecilia and Gene Doo**

**Value:** \$125

---

## 233 *Romance on the Beach*

Four \$50 gift certificates for Michel's, where all five senses are enchanted and romanced. *Not redeemable for credit or gratuity. Expires December 12, 2010.*

**Michel's at the Colony Surf**

**Value:** \$200

---

## 234 *Duckhorn Merlot*

Six bottles of 2006 Duckhorn Napa Valley Merlot. This Merlot offers a rich texture, ripe tannins and seamlessly integrated French oak. The bouquet displays lush layers of ripe plum and bright raspberry underscored by notes of sandalwood, walnut and spice. On the palate, polished flavors of red cherry and raspberry are accented by an enticing layer of graham cracker piecrust.

**Jack and Leilani Maguire**

**Value:** \$320

---

### 235 *Roy's Waikiki*

Step out for an evening at Roy's Waikiki with a \$100 gift certificate. *Only redeemable for food. Does not include alcohol, beverages, tax and gratuity. Not redeemable for cash or change in the form of cash or another donation certificate. Only this original donation certificate will be accepted. Only redeemable at Roy's Waikiki. No take-out orders. Not valid for special events. Expires December 12, 2010.*

**Roy's Restaurant Waikiki**

**Value:** \$100

---

### 236 *2005 Merus*

2005 Merus Cabernet Sauvignon is a cult Napa Valley Wine. The wine is dense purple-colored to the rim, with an exquisite nose of charcoal, graphite and blackberry liqueur. Full-bodied, with great power, richness and sensational length, this wine will benefit from four to five years of bottle age and last three decades. 96+ points by Robert Parker.

**Cedric and Patricia Choi**

**Value:** \$200

---

### 237 *Mamma Mia!*

Two \$50 gift certificates for dining at Sergio's Italian Restaurant on Kapahulu Avenue. Known for fresh pastas, Tuscan pizzas and integrating the finest fresh, local and imported products from Italy. *No cash value. Not extendable. Expires December 12, 2010.*

**Sergio's Italian Restaurant**

**Value:** \$100

---

### 238 *The Prisoner 2006*

A 1.5 liter bottle of 2006 The Prisoner Napa Valley Red Wine blends the lush berry flavors of Zinfandel, power and concentration of Cabernet Sauvignon, with Syrah, Petit Syrah, Charbono and Grenache to combine for a decadent wine with great complexity.

**Mr. and Mrs. Watters O. Martin, Jr.**

**Value:** \$90

---

### 239 *Double Nobu*

One bottle of Nobu Matsuhisa "Private Selection" Cabernet Sauvignon Napa '06 and one bottle of Nobu Matsuhisa Chardonnay Russian River Valley '06.

**Nobu Waikiki**

**Value:** \$150

---

## 240 *Let Us Entertain You!*

Four seats in section A to a Saturday matinee for any show in our remaining 2009/2010 season. Upcoming show in the 2009-2010 season are *The Joy Luck Club*, *Shout!*, *The Mod Musical*, *Guys and Dolls*, and *The Sound of Music*. Based on availability. Expires August 31, 2010.

**Diamond Head Theatre**

**Value:** \$130

---

## 241 *Papillon 2006*

A 1.5 liter 2006 Papillon Napa Valley Red Wine is Orin Swift Cellars' second release of the Papillon and is comprised primarily of Cabernet with Merlot, Petit Verdot, Cabernet Franc and Malbec rounding out the blend. Aromas of with notes of campfire, toast and sweet vanilla dominate. On the palette it has wild strawberry, rhubarb and saffras. The finish has an impression of cherry pie. The label is a photo taken by world-renowned photographer and wine lover, Greg Gorman.

**Mr. and Mrs. Watters O. Martin, Jr.**

**Value:** \$140

---

## 242 *Shangri La Private Tour*

Private tour of Shangri La for four people. Shangri La houses an impressive collection of Islamic art and is considered one of Hawaii's most architecturally significant homes. *Must provide own transportation and arrive in one car. Expires December 12, 2010.*

**Doris Duke Foundation for Islamic Art**

**Value:** \$600

---

## 243 *Peter Michael 2006 Belle Cote*

2006 Chardonnay Belle Cote "is a large-scaled wine, but with flamboyant marmalade, white currant, honeysuckle, and tropical fruit notes, less minerality than La Carriere, but beautiful acidity and a stony, steely personality not dissimilar to a grand cru in Burgundy such as Corton-Charlemagne." Robert Parker. WA 93.

**Kimberly Case**

**Value:** \$175

---

## 244 *Peter Michael Chardonnay La Carriere 2006*

"One of my favorite cuvees is always La Carriere. The 2006 La Carriere displays wonderful honeyed grapefruit, crushed rock, and some spicy, yeasty notes along with nectarine and honeyed citrus. The wine is rich, full-bodied, with a striking minerality." Robert Parker. WA 92.

**Kimberly Case**

**Value:** \$175

---

## 245 *La Bohème*

Two tickets to Hawai'i Opera Theatre's production of *La Bohème* on March 2, 2010. Must redeem by December 31, 2010.

**Hawaii Opera Theatre**

**Value:** \$170

---

## 246 *Royal Style*

\$150 gift certificate for dinner for two to Azure at the Royal Hawaiian Hotel. Not valid on holidays. Does not include alcoholic beverages. Gratuity not included. Reservations required. Not redeemable for cash. Expires December 15, 2010.

**Azure, The Royal Hawaiian,  
A Luxury Collection Resort**

**Value:** \$150

---

## *Home*

### 301 *A Table for You*

Queen Anne style koa wood round table. The diameter is 47 1/2" and it is a period reproduction.

**Anonymous**

**Value:** \$1,500

---

### 302 *Reflections*

Large, gold-framed mirror with a matching gilded base with a marble top.

**Anonymous**

**Value:** \$2,500

---

### 303 *Light Up*

A pair of gold floor lamps with shades.

**Anonymous**

**Value:** \$1,600

---

### 304 *Table Dressing*

Set of four Royal Dresden vintage porcelain candle and floral holders for centerpiece arrangements in the Four Seasons pattern.

**Timothy Y.C. Choy**

**Value:** \$300

---

### 305 *Waterford Decanter*

Master Cutter Claret Decanter from Waterford's Prestige Collection. Only Waterford's finest Master Craftsmen produce this collection. Intricate detailing and deep cutting make this crystal masterpiece something to be treasured.

**Anonymous**

**Value:** \$1,800

---

*306 Waterford Crystal Clock*

Waterford crystal clock with scallop shape.

**Timothy Y.C. Choy**

**Value:** \$100

---

*307 Sweet!*

Gump's sterling silver sugar caster.

**Anonymous**

**Value:** \$200

---

*308 Sterling Refill*

Wallace sterling silver water pitcher.

**Anonymous**

**Value:** \$300

---

*309 Silver Bowls*

A pair of Mexican sterling oval bowls with scalloped borders.

**Samuel and Mary Cooke**

**Value:** \$1,000

---

*310 Bird Sculpture*

Large bird carved from labradorite from Germany with sterling silver feet and tiger-eye beak.

**Anonymous**

**Value:** \$1,200

---

*311 Kingfisher*

A carved gemstone from Germany with labradorite, tiger eye beak and sterling silver feet.

**Anonymous**

**Value:** \$750

---

*312 Bronze Dog*

Unsigned bronze dog on a black marble base.

**Anonymous**

**Value:** \$300

---

*313 A Red Carpet*

Kilim-type wool carpet with a beige diagonal medallion on a red field of diamonds. 52" x 92".

**Anonymous**

**Value:** \$300

---

314 *“Le Pont Japonais”*

Framed Claude Monet “Le Pont Japonais” serigraph.

**Mr. and Mrs. H.C. Sharp**

**Value:** \$250

---

315 *“Promenade près d’Argenteuil”*

Framed “Promenade près d’ Argenteuil” serigraph by Claude Monet.

**Mr. and Mrs. H.C. Sharp**

**Value:** \$250

---

316 *Marble Pedestal 1*

Marble in hues of red and green form a 39” pedestal that can be used in a variety of ways.

**Anonymous**

**Value:** \$500

---

317 *Marble Pedestal 2*

Marble in hues of red and green form a 39” pedestal that can be used in a variety of ways.

**Anonymous**

**Value:** \$500

---

318 *Kremlin Churches*

This fine print of the famous churches found in the Kremlin, Moscow is signed by the artist, double-matted and displayed in a beautiful antiqued frame.

**Anonymous**

**Value:** \$325

---

319 *Hudson Watercolor*

Framed water color by Winifred Hudson.

**Anonymous**

**Value:** \$300

---

320 *Matching Vases*

A pair of Chinese porcelain vases with tapered square sides decorated in black glaze with bird and floral motif. They are contemporary pieces.

**Anonymous**

**Value:** \$200

---

321 *Seated Guanyin*

Chinese carved wood seated guanyin figurine, circa the late 18th or early 19th century.

**Anonymous**

**Value:** \$600

---

322 *Temple Garden Figure*

Chinese carved gilt lacquered Taoist temple guardian figurine from the 19th century.

**Anonymous**

**Value:** \$200

---

323 *Antique Buddha*

Antique Chinese carved gilt wood Buddha.

**Anonymous**

**Value:** \$800

---

324 *Taoist Deity*

Chinese carved gilt lacquered Taoist deity, 19th Century.

**Anonymous**

**Value:** \$300

---

325 *Tree of Life Rug*

A contemporary silk Chinese rug in the Persian "Tree-of-Life" design with a bird and animal motif, 90" x 63".

**Anonymous**

**Value:** \$2,500

---

326 *Throw Rug Set*

Three square Chinese throw rugs in the "Blue Dragon" design.

**Anonymous**

**Value:** \$150

---

327 *Garden Temple*

A contemporary Chinese wood garden temple, 41" in height, on bamboo chest stand, 17" in height.

**Anonymous**

**Value:** \$1,000

---

328 *Peachy Vase*

Contemporary Chinese porcelain vase with a peach motif and a wood stand.

**Anonymous**

**Value:** \$300

---

329 *Happy Pair*

Twin Chinese porcelain hotel.

**Sam and Zoe Cooke-Cummins**

**Value:** \$50

---

330 *Tang Figurine*

Contemporary Chinese porcelain figurine in the Tang style.

**Anonymous**

**Value:** \$300

---

331 *Happiness and Luck*

Chinese porcelain happy hotel.

**Mr. and Mrs. Watters O. Martin, Jr.**

**Value:** \$80

---

332 *Longquan Ware Bowl*

Chinese Longquan ware porcelain bowl with molded floral design, probably Qing dynasty.

**Anonymous**

**Value:** \$50

---

333 *Melrose Set*

Late 18th-century, antique eggshell porcelain in the China Melrose pattern. There are dishes and serving pieces for six people. The set includes a teapot, creamer, sugar bowl, gravy bowl, serving dish with lid, small bowl with lid, circular plate, soup bowl, diamond serving dish, oval serving platter, toothpick holder with lid, six dinner plates, six dessert plates, three coffee cups, one tea cup and six saucers. A gem of Chinese ceramics, eggshell china is remarkable first of all for its extraordinary thinness. Yet it is appreciated also because it is spotlessly white, translucent, and sonorous when tapped. Exquisite!

**Barbara and Sonny Ching**

**Value:** \$4,500

---

334 *Spirit Stone*

Spirit stone from China with a rosewood stand.

**Ernest and Letah Lee**

**Value:** \$100

---

335 *Peking Glass*

A pair of Peking glass containers.

**Ernest and Letah Lee**

**Value:** \$50

---

336 *Guanyin Bell*

Chinese carved soapstone Guanyin Vajra bell, 17th century.

**Anonymous**

**Value:** \$500

---

337 *Imperial Lacquer*

From the purveyors to Japan's Imperial Household for generations come a set of six lacquer cups and saucers lined in 24K gold. This precious set was obtained from the Takahashi family of San Francisco. History and care included.

**Anonymous**

**Value:** \$600

---

338 *Buddha Head*

Mounted Buddha head.

**Mary Nurse and Stacy Rogers**

**Value:** \$200

---

339 *Bird and Willow Jar*

Japanese bronze jar with relief design of bird and willow from about 1900.

**Anonymous**

**Value:** \$175

---

340 *Geese Over Mountain Vase*

Japanese bronze vase with silver borders and geese over mountain motif.

**Anonymous**

**Value:** \$150

---

341 *Meiji Vase*

Japanese bronze Champlève baluster vase is signed Shimasa from the Meiji period (1868-1912).

**Anonymous**

**Value:** \$275

---

342 *Root Wood Bird*

Japanese root wood carving of a bird on a base.

**Anonymous**

**Value:** \$100

---

343 *Floral Vase*

Japanese bronze vase with floral motif is signed and is contemporary.

**Anonymous**

**Value:** \$100

---

344 *Artistic Light*

Japanese Kutani vase wired to be used as a lamp.

**Anonymous**

**Value:** \$125

---

345 *Bird and Foliage Meiji Vase*

Japanese bronze vase with panels of birds and foliage from the Meiji period, 19th century.

**Anonymous**

**Value:** \$500

---

346 *Samurai Shin Guard*

Antique Japanese Samurai Shin Guard in a frame from the early to mid-1800s.

**Peter and Kimberly Backus**

**Value:** \$500

---

347 *Hibachi*

Japanese wood hibachi with liner. 14" diameter, 9 1/2" in height.

**Anonymous**

**Value:** \$250

---

348 *Blue Porcelain Vase*

Twentieth century Japanese porcelain vase with a light blue glaze and ovoid shape by Takeuchi. A box is also included.

**Anonymous**

**Value:** \$300

---

349 *Bronze Kannon Figure*

Japanese bronze Kannon, the Bodhisattva of Compassion.

**Anonymous**

**Value:** \$150

---

350 *Carved Mochizuke*

A carved black granite stone for mochi pounding.

**Anonymous**

**Value:** \$350

---

351 *Carved Mochizuke Too*

Carved mochizuke of mortar stone for mochi pounding.

**Anonymous**

**Value:** \$350

---

352 *Storage Jar*

Contemporary Oriental design black pottery storage jar with a ribbed body.

**Anonymous**

**Value:** \$500

---

353 *Edo Chest*

Reddish brown lacquered chest from the Japanese Edo period circa the 19th century.

**Anonymous**

**Value:** \$800

---

354 *Standing Buddha*

Japanese Edo period gilt wood standing Amida Buddha.

**Anonymous**

**Value:** \$400

---

355 *Tea Bowl*

Tea bowl by Shige Yamada, 1970. Yamada is a Maui-born artist who is the sculptor of three major state commissions.

**Ernest and Letah Lee**

**Value:** \$200

---

356 *Hanging Scroll*

Japanese hanging scroll.

**Anonymous**

**Value:** \$350

---

357 *Four Handscrolls*

Reproductions of the *Tale of Genji* handscrolls. A set of four handscrolls in a box from the collection of Edward G. Seidensticker, noted translator of the *Tale of Genji* into English.

**Anonymous**

**Value:** \$400

---

358 *Bronze Heron*

Japanese bronze heron on a stylized water motif base from the late Meiji period, circa 1900.

**Anonymous**

**Value:** \$475

---

359 *Bird and Bamboo Vase*

Japanese bronze vase with a relief design of bird and bamboo. The piece is signed and from the 20th century.

**Anonymous**

**Value:** \$1,000

---

360 *Footed Jar*

Korean Silla period footed jar has low compressed body and a high pedestal foot.

**Anonymous**

**Value:** \$100

---

361 *Yi Dynasty Bottle*

Korean Yi dynasty bottle with an ovoid body and a low flaring mouth rim.

**Anonymous**

**Value:** \$200

---

362 *Footed Covered Bowl*

Korean Silla period footed and covered bowl with a tall tapered foot.

**Anonymous**

**Value:** \$700

---

363 *Silla Pedestal*

Korean Silla period round pedestal raised on tall tapered foot.

**Anonymous**

**Value:** \$500

---

364 *Burmese Storage Container*

Burmese red lacquer footed storage container with cover.

**Anonymous**

**Value:** \$200

---

365 *Antique Kneeling Monk*

A large antique Thai kneeling monk. Made of gilt lacquer with robe highlighted with cut glass. This is a highly collectible piece.

**Anonymous**

**Value:** \$700

---

366 *Sacred Art and Geometry*

Vintage black and gold-leaf Tibetan mandala from the mid-1900s.

**Catherine Cooke and Les Ihara**

**Value:** \$280

---

367 *Tibetan Mandala*

Vintage red and gold-leaf Tibetan mandala from the mid-1900s.

**Susan Dorsey & Van Whiteman**

**Value:** \$280

---

368 *Multicolor Mandala*

Vintage multicolor and gold-leaf Tibetan mandala from the mid-1900s.

**Laurens Laudowicz**

**Value:** \$280

---

369 *Carved Door*

Carved wood door with figures.

**Anonymous**

**Value:** \$600

---

370 *Court Dancers*

Original pen and ink drawing by a Malaysian artist depicting court dancers. Custom framed in ebony with a mat and French lines. Non-glare glass.

**Anonymous**

**Value:** \$500

---

371 *Kuala Lumpur Parliament*

Beautifully rendered pen and ink drawing by a Malaysian artist of the famous Parliament Building in Kuala Lumpur, Malaysia. Custom framed in ebony with a cream mat and French lines. Non-glare glass.

**Anonymous**

**Value:** \$500

---

372 *Bali Festival*

An oil painting of a festival scene on Bali, circa 1990s.

**Robert Morishige**

**Value:** \$400

---

373 *Beach Reflection*

Locally made island shell mirror. *Non-refundable, no returns or exchanges.*

**Macy's**

**Value:** \$500

---

374 *Polynesian Bowl*

Ceremonial Polynesian Bowl.

**John Stephenson**

**Value:** \$450

---

375 *O'o*

Contemporary koa wood digging stick is 67" in length.

**Anonymous**

**Value:** \$325

---

376 *One Paddle*

Wooden paddle, origin unknown, 58 1/2" length.

**Anonymous**

**Value:** \$150

---

377 *Koa Vase*

Contemporary koa wood vase, signed LeBuse on base.

**Anonymous**

**Value:** \$350

---

378 *Mask with Mother of Pearl*

Reproduction carved wood mask with mother-of-pearl eyes.

**Anonymous**

**Value:** \$100

---

379 *Alani Apio Bowl*

Koa wood bowl with a beveled lip, by Alani Apio.

**Anonymous**

**Value:** \$600

---

380 *Hawaiian Hand Stand*

A reproduction of a wood carving of a Hawaiian figure standing on its hands.

**Anonymous**

**Value:** \$200

---

381 *Milo Bowl*

Milo wood bowl.

**Anonymous**

**Value:** \$50

---

382 *Lau Lau Woodworks*

\$100 gift certificate for Lau Lau Woodworks. Lau Lau Woodworks is a company dedicated to celebrating the natural beauty of wood by creating high-quality writing instruments and other exceptional items primarily made of Hawaiian woods. *Gift certificate only good for Hawaiian koa pens hand-crafted by Aaron Lau. No cash value. Good for one purchase only. Not replaced if lost or stolen. Expires November 1, 2010.*

**Lau Lau Woodworks**

**Value:** \$100

---

383 *Hawaiian Bowl*

Carved wood Hawaiian figural bowl sculpture with mother-of-pearl eye.

**Anonymous**

**Value:** \$1,000

---

384 *Anagama By Amemiya*

Ceramic sculptural flower vessel, an original art work by Clayton Amemiya, was fired in Anagama-style kiln which produces distinctive pottery. Anagama is the oldest style kiln in Japan.

**Patricia Salmon**

**Value:** \$500

---

385 *Sake or Martini Set*

Sake or martini set by Geoff Lee is a four-piece handblown glass set by local artist Geoff Lee and includes three cups and one beaker for sake or martinis.

**Timothy Y.C. Choy**

**Value:** \$150

---

386 *Tra La La*

A pair of Christmas ornaments handmade by artist Rochelle Lum.

**Anonymous**

**Value:** \$250

---

387 *Oriental Santa*

An lone Adams oriental Santa in burgundy and gold.

**Anonymous**

**Value:** \$300

---

388 *Get Organized*

Two hours of consulting services for home, office or teenager. *Date and time to be mutually agreed upon. Expires December 12, 2010.*

**SPI Consulting**

**Value:** \$220

---

389 *Surf's Up*

Keep on surfing with a Local Motion body board and board bag. *Cannot be returned or exchanged.*

**Anonymous**

**Value:** \$135

---

### 390 *Green Honolulu*

Green Honolulu is offering you four seasonal floral arrangements: winter, spring, summer and fall 2010. *All orders must be placed two weeks in advance. Expires December 12, 2010.*

**Green**

---

### 391 *Tango Monastery*

Photograph by Shuzo Uemoto of the Zimkhang Chapel at the Tango Monastery, Thimphu District, Bhutan. This photograph was taken in 2007 and part of the *The Dragon's Gift: The Sacred Arts of Bhutan* exhibition at the Honolulu Academy of Arts.

**Shuzo Uemoto, Honolulu Academy of Arts**

**Value:** \$400

---

## *Adornments*

### 401 *Carved Coral Pendant*

Hand carved, ox-blood color pendant created from the finest Mediterranean coral set in 14K bezel with 14K gold.

**Anonymous**

**Value:** \$4,500

---

### 402 *Sack in the City*

Balenciaga classic city handbag, a fashionista's must-have in raisin, one of the hottest colors of fall 2009. Crafted in Italy of soft lambskin and featuring aged brass hardware and hand-stitched handles, it has become the iconic handbag of this prestigious design house. *No refunds or exchanges.*

**Neiman Marcus**

**Value:** \$1,395

---

### 403 *Venetian Beads*

Multi-colored Venetian foil beads with gold accoutrements.

**Russell Lowrey**

**Value:** \$100

---

### 404 *I Love Louis*

A classic denim tote with the LV logo in cerise. *Item cannot be exchanged for merchandise or credit at any Louis Vuitton store.*

**Louis Vuitton**

**Value:** \$1,160

---

405 *Koa Jewelry Box*

Large dome-shaped koa jewelry box.

**Anonymous**

**Value:** \$1,200

---

406 *Style*

Salvatore Ferragamo black calf leather tote bag. *No refunds or exchanges.*

**DFS Hawaii**

**Value:** \$640

---

407 *Coin Pearl Necklace and Earring Set*

The necklace consists of two strands of peridot seed beads with three grey coin pearls, Bali beads and sterling. The earrings complete the look.

**Masae by Rebecca Ohta**

**Value:** \$120

---

408 *PRADA at Night*

PRADA evening bag in hot pink satin with large emerald-cut, jewel-colored rhinestones. To add to its versatility, the patent strap is removable. *Cannot be returned or exchanged.*

**Anonymous**

**Value:** \$590

---

409 *Silver and Bead Necklace*

One-of-a-kind necklace incorporating various kinds of beads and silver.

**Sharon Kim Venegas**

**Value:** \$375

---

410 *Macy's Gift Certificate*

A \$250 gift certificate just in time for Christmas shopping. It's the perfect gift! *Not redeemable for cash or applied as payment or credit to any credit card account. Not replaced if lost or stolen. Valid at any Macy's store nationwide or online at macys.com.*

**Macy's**

**Value:** \$250

---

411 *Venetian Glass Earrings*

Asymmetrical earrings made with tagliamonte Venetian glass sea shell and sea horse. Made in Italy of 14K gold and sterling silver.

**Linda Lee**

**Value:** \$200

---

412 *Easy YSL*

Yves Saint Laurent medium tote bag in black patent leather is both easy and chic. *No refunds, returns or exchanges.*

**Yves Saint Laurent**

**Value:** \$995

---

413 *Venetian Glass Necklace*

Tagliamonte Venetian glass sea necklace. Made in Italy of 14K gold and sterling.

**Linda Lee**

**Value:** \$800

---

414 *Always Chic*

Dior soft medium sized shopping bag. *No returns or exchanges.*

**Christian Dior**

**Value:** \$1,590

---

415 *Fabric Poetry*

The rich and beautiful products of the Indian weavers have been rightly called "exquisite poetry in colorful fabrics." Intricately woven Indian textile is approximately 6' X 9'.

**Indru and Gulab Watumull**

**Value:** \$800

---

416 *White Jade*

Rare pure white nephrite jade necklace, handmade in a simple braid with traditional Chinese silk.

**Jade Gallery Hawaii**

**Value:** \$300

---

417 *Gucci Tote*

Sukey medium tote in silver guccissimz leather. *Cannot be returned or exchanged.*

**Gucci**

**Value:** \$1,295

---

418 *Pampering*

Gift certificate for a haircut with Paul Brown, manicure with Violet and makeup application with George plus a gift certificate for a custom 50 minute massage at Spa Olakino and a gift basket with Paul Brown products. *Gift certificates expire March 12, 2010.*

**Paul Brown Salon & Day Spa**

**Value:** \$415

---

## 419 *Hermes Home*

Wooden sawah bowl and matching stand. *No returns, refunds or exchanges.*

**Hermes**

**Value:** \$670

---

## 420 *Relax!*

Three gift certificates, each good for either a one-hour relaxation massage session or a learning massage session for a parent and a child of any age.

**First Massage Service for Children, LLC**

**Value:** \$400

---

## 421 *Get Dressed*

Tori Richard \$250 gift certificate to be used toward the purchase of Tori Richard brand merchandise at any Tori Richard store. *No changes or store credit given. Can be used at the following Tori Richard stores: Ala Moana Center, the Hyatt Regency Waikiki, Hilton Hawaiian Village or the Shops at Wailea, Maui. Credit can only be used on Tori Richard brand merchandise. Expires December 12, 2010.*

**Tori Richard, Ltd.**

**Value:** \$500

## *Travel*

### 501 *Land of the Thunder Dragon*

Make a peaceful pilgrimage through Bhutan with Aman Resorts—stay at five lodges, nestled strategically through Bhutan's mountainous landscape. The journey will begin with two nights accommodations at Aman New Delhi, then continues to Bhutan, with eight nights accommodations in a suite for two at any combination of four lodges—Amankora Paro, Thimphu, Gangtey and Bumthang. *Blackout dates are listed on gift certificate. Voucher must be presented at check-in. Not transferable or redeemable for cash. Expires December 11, 2010.*

**Amankora, Aman New Delhi**

**Value:** \$12,300

---

### 502 *Bangkok Mandarin Style*

Luxuriate at one of *Travel & Leisure's* consistent winners of the "Best Hotels in the World" award. Deluxe room for three nights (double occupancy) at the Mandarin Oriental, Bangkok. Eminently stylish facilities such as acclaimed spas and pools serviced by discreet butlers make your stay memorable. *Not applicable between December 20 2009 and January 10, 2010, nor in February 2010 or November 2010. Subject to print reservation as well as space availability. Must present voucher at check-in. Expires December 14, 2010.*

**Jan D. Goessing, Mandarin Oriental Bangkok**

**Value:** \$1,835

---

### 503 *Renaissance Dream*

One-week stay at "Maison du Mettre," a terraced home set on the edge of the medieval village of Caramany in the Roussillon region of Southeast France, the land of the Da Vinci Code. This five-bedroom, two-bath house accommodates up to ten people. The 400-year-old structure is just steps to gourmet restaurants and minutes to the Mediterranean beaches, Languedoc vineyards and Pyrenées skiing. *Date and time to be mutually agreed upon. Expires December 12, 2010.*

**Christopher Herrmann**

**Value:** \$3,500

---

### 504 *Ultimate Vermont*

A two-night stay in a cottage at Twin Farms, a four-season country estate getaway. Situated on more than 300 acres of wildflower meadows, hardwood forests, ancient gardens and private ponds in Barnard, Vermont, Twin Farms is just ten miles north of picturesque Woodstock. Guests enjoy the use of a handsome pub, fitness center, spa treatment facility, lakeside cabana and a Japanese-style furo. On-site recreation and equipment, ground transfer from area airports, outstanding cuisine and fine wines are included in the base rate. Based on availability. *Not valid on public holidays. Requires reservations. Only valid Sundays through Thursdays. The value of the room specified is not negotiable or transferable. All other booking conditions apply. Expires December 12, 2010.*

**Twin Farms and Sharon and Thurston Twigg-Smith**

**Value:** \$5,200

---

### 505 *Big Island Luxury*

Gift certificate for a two-night stay in ocean-view accommodations (double occupancy) at the Mauna Lani Bay Hotel. The cultural tour of preserved Hawaiian fishponds and petroglyphs is outstanding. *Based on availability. Excludes period of December 20, 2009 through March 31, 2010. Certificate must be presented at Check-in. Not redeemable for cash. Expires December 19, 2010.*

**Mauna Lani Bay Hotel and Bungalows**

**Value:** \$1,570

---

### 506 *Aloha Maui*

Three-night stay in ocean-view accommodations. Enjoy the lush, Polynesian beauty of Grand Wailea, an elegant island hideaway providing incomparable relaxation and adventure. *Reservations required. Not available during holiday periods. Not redeemable for cash. Resort is not responsible if lost or stolen. Certificate is void if altered or changed in any way. Expires December 31, 2010.*

**Grand Wailea Resort Hotel and Spa**

**Value:** \$2,455

---

## 507 *Tropical Escape*

When the Princeville Resort got a makeover and reopened as a St. Regis property in September, it marked the legendary brand's first resort in Hawaii. Be the first to discover "Hawaii's Quintessential Address" overlooking Hanalei Bay. The resort is also home to internationally renowned chef Jean-Georges Vongerichten's Kauai Grill. Five days and four nights. *Based on space availability. Reservations required. Not redeemable for cash. Blackout dates from December 23, 2009 to January 3, 2010. Expires December 12, 2010.*

**St. Regis Princeville Resort**

**Value:** \$4,600

---

## 508 *Experience Waikiki*

A gift certificate for a two night accommodation in an ocean-view room. The energy of Waikiki is infectious and the Marriott in the heart of it. *Reservations based on space and rate availability. Expires December 12, 2010.*

**Waikiki Beach Marriott Resort & Spa**

**Value:** \$765

---

## 509 *Resort Renewal*

Hotel Renew in Waikiki delights with dramatic lighting, striking artwork and elegant guest rooms with an intimate atmosphere created in the spirit of wellness, ease and comfort. One-night stay in a city-view room. Includes continental breakfast and complimentary Wi-Fi. *Based on availability.*

**Hotel Renew**

**Value:** \$305

---

## 510 *Hilton Escape*

Ocean-view accommodations for two people for one night at the Hilton Hawaiian Village Beach Resort & Spa. Lush tropical gardens, waterfalls, exotic wildlife and priceless artwork make this one-of-a-kind Honolulu hotel the only true resort property in Waikiki. *Based on availability, expires December 12, 2010.*

**Hilton Hawaiian Village Beach Resort & Spa**

**Value:** \$540

---

### 511 *Waikiki Calls*

The Sheraton Waikiki Hotel and Resort is your gateway to Hawaii's favorite playground, Waikiki Beach. Two-night stay in an ocean-front room at the Sheraton Waikiki plus a \$100 dining gift certificate at Kai Market, a new farm-to-table eatery at the Sheraton Waikiki. *Gift certificates are not valid on holidays, will not be replaced if lost or stolen and are not redeemable for cash. Room certificate will be based on availability and blackout dates apply. Dining certificate does not include gratuity or alcoholic beverages. Expires December 12, 2011.*

**Starwood Hotels & Resorts Waikiki and  
Kyo-ya Hotels & Resort, LP**

**Value:** \$1,270

---

### 512 *Heavenly Water*

A one-week stay in a Lanikai waterfront home with three bedrooms and two baths, sleeps six. Spend an idyllic week on the beach without the plane ride. *No smoking, no pets. Maximum of 6 people. Date to be mutually agreed upon. Expires December 12, 2010.*

**Kitty and Buzz Wo**

**Value:** \$1,500

---

### 513 *Sunset Weekend*

Spend a weekend at Randy and Lynne's North Shore retreat on Sunset Beach. A two-story redwood house sleeps five people in three bedrooms and has two and one-half baths. An outside shower completes the beach experience. *Five people max, no pets, no smoking. Date to be mutually agreed upon. Certificate expires December 12, 2010.*

**Lynne Johnson & Randy Moore**

**Value:** \$1,500

---

### 514 *North Shore Fun*

Stay at the Turtle Bay townhouse of Kenneth and Shaunagh Robbins. The two-bedroom, two-bath townhouse with a loft sleeps six people. Completely refurbished and upgraded, it is located on the first fairway of the Fazio Golf Course. *No pets. Date to be mutually agreed upon and based on availability. Expires December 12, 2010.*

**Kenneth and Shaunagh Robbins**

**Value:** \$725

---